



Registered trademark

OPERATOR'S MANUAL

Cellu M6[®]

KEYMODULE [2] i

**Please read the complete manual carefully
before using your equipment.**

© Copyright LPG Systems 2007. LPG, Cellu M6, Keymodule and Endermologie Photo System are registered trademarks of LPG.
Reproduction, even in part, is strictly prohibited.

GU 350

Edition A dated 03/07

LPG[®]

Congratulations on the purchase of your Cellu M6 Keymodule [2] i. This model represents the fruits of numerous years of experience in the design and production of cutaneous tissue treatment systems. You will experience fully the technical perfection and reliability of LPG Systems, which is the leader in this sector. This operator's manual contains the operating description, basic maintenance instructions to be performed periodically and the safety instructions. You are reminded that your device is designed for the treatment of connective tissue and that it must only be used by a professional trained by LPG Systems or an authorized distributor if you live outside France. If you have any doubts whatsoever concerning the operation or maintenance of your equipment, please do not hesitate to contact LPG the Customer Service Department of your distributor.



In order to respond better to customer requirements or expectations, LPG Systems is continuously researching ways of improving the design and quality of its products. This will explain the few minor differences between your equipment and the item described in this guide. If you own a Cellu M6 Keymodule i, some chapters of this user guide do not apply as specified in this document.

Package contents

- One Cellu M6 Keymodule [2]i unit
- One main T70 head
- Three Keymodule
- One supply cable
- A set of auxiliary heads
- A set of micro-nozzles/micro-heads
- A set of lift heads
- One operator's manual
- One maintenance kit
- Marketing environment

Table of contents

1	DESCRIPTION OF THE UNIT	P. 6
2	DESCRIPTION OF THE CONTROLS	P. 8
3	PRECAUTIONS FOR USE.....	P. 9
4	MAINTENANCE.....	P. 11
5	OPERATING FAULTS	P. 21
6	TECHNICAL SPECIFICATIONS	P. 22
7	TREATMENT HEADS	P. 24
8	WARRANTY	P. 39
9	ACCESSORIES	P. 42

Cellu M6® Keymodule [2]i

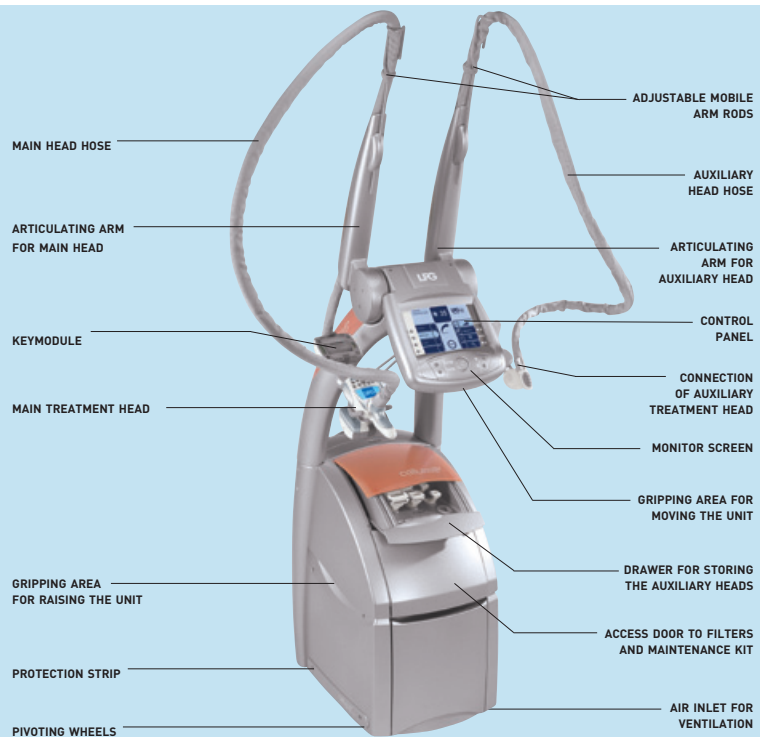

- MAIN HEAD HOSE
- ADJUSTABLE MOBILE ARM RODS
- AUXILIARY HEAD HOSE
- ARTICULATING ARM FOR MAIN HEAD
- ARTICULATING ARM FOR AUXILIARY HEAD
- CONTROL PANEL
- KEYMODULE
- CONNECTION OF AUXILIARY TREATMENT HEAD
- MONITOR SCREEN
- MAIN TREATMENT HEAD
- GRIPPING AREA FOR MOVING THE UNIT
- GRIPPING AREA FOR RAISING THE UNIT
- DRAWER FOR STORING THE AUXILIARY HEADS
- PROTECTION STRIP
- ACCESS DOOR TO FILTERS AND MAINTENANCE KIT
- PIVOTING WHEELS
- AIR INLET FOR VENTILATION

BEFORE USE MAKE SURE THAT THE SUPPLY CABLE IS COMPLETELY UNWOUND

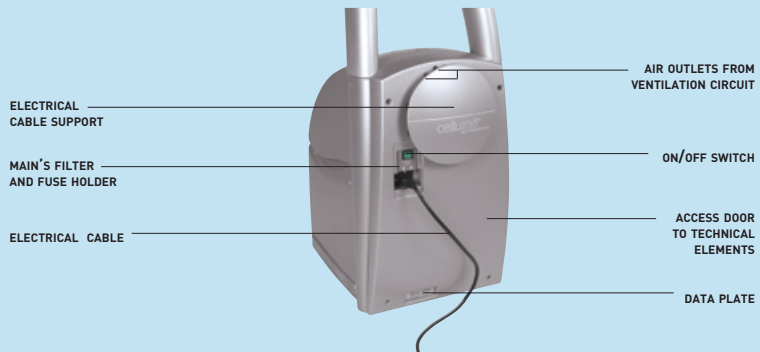

- ELECTRICAL CABLE SUPPORT
- AIR OUTLETS FROM VENTILATION CIRCUIT
- MAIN'S FILTER AND FUSE HOLDER
- ON/OFF SWITCH
- ELECTRICAL CABLE
- ACCESS DOOR TO TECHNICAL ELEMENTS
- DATA PLATE

Drawer for storing the series 600 auxiliary heads



Cellu M6 Keymodule [2]i

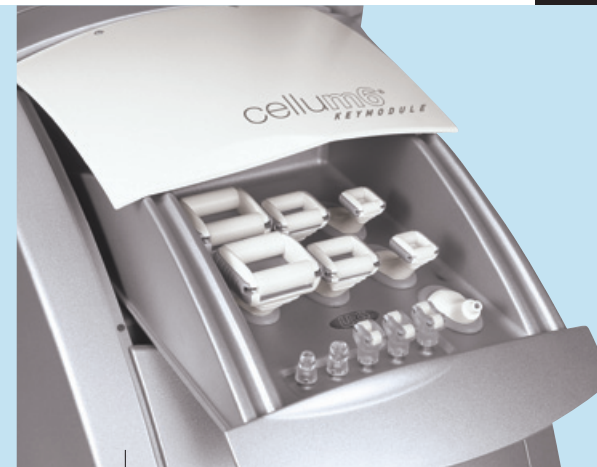

Cellu M6 Keymodule i*

Access to the filters

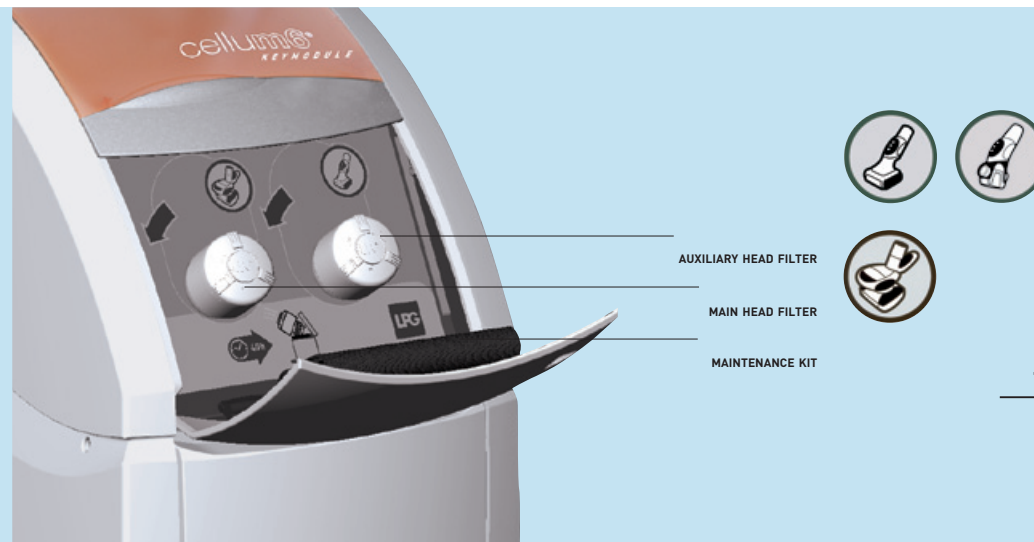

- AUXILIARY HEAD FILTER
- MAIN HEAD FILTER
- MAINTENANCE KIT

! The unit can only operate if it is connected to the mains by its supply cable and provided the ON switch has been actuated and the green voltage light is on. When the unit is switched on, the pump starts to run automatically for about ten seconds for priming.

! * The auxiliary heads are replaced by the 600 series auxiliary heads.

Control panel



Main head



Precautions

- Check that the supply voltage of the unit indicated on the data plate complies with the mains voltage.
- The unit must be connected to a grounded outlet in accordance with current electrical standards.
- Never use the unit on a dusty, uneven floor, or in a moist atmosphere.
- Check that the inlet to the ventilation circuit is always unobstructed.
- Fully unwind the supply electrical from its support to ensure good ventilation of the unit.
- Switch the unit off if it is not going to be used for a long period. In this case, operate the machine for a 1/2 an hour approximately every 8 weeks.
- Do not allow solid debris or liquid to be sucked into the unit, as these could cause damage.
- Never use the auxiliary adapter as a treatment head or allow it to come into direct contact with the skin.
- Do not use the main head to carry out treatment on the scalp.
- Only use the treatment heads supplied with your unit or recommended by LPG.
- Only use LPG Systems treatment garments.
- Never use the unit for purposes other than those recommended by LPG Systems.
- LPG Systems will not be liable for any inappropriate use of the equipment.
- With respect to treated tissue, some parameters may cause pain or tissue lesions. The operator must be particularly attentive to the sensations felt by the person undergoing treatment where:
 - the intensity is greater than 4 in continuous or sequential mode (for frequencies less than 4 Hz),
 - the system has changed to reverse mode (rollers rotating in opposite direction).
- The operator must ensure that the parameters (intensity, sequentiality, differential...) are always adapted to the cutaneous tissue being treated.
- You are advised to rest the device for 10 minutes between each 35-minute treatment session when using it at a room temperature higher than 25°C (77°F).



Where the unit has not been used for a long time, it is possible that marks may form on the ground where the wheels are. This phenomenon is the result of a chemical reaction between the components of some floorings and those of the wheels of the Cellu M6 Keymodule [2] i.

Contra-indications

- Do not treat open wounds, the eyes, intra-cavity areas, mucous membranes, the genitals and breasts.
- In the event of pregnancy, do not treat the lumbar-abdominal region. Consult with the doctor with regard to this treatment.
- Do not treat a patient with an infectious disease, a growing tumour, phlebitis etc.
- Consult with the doctor where the subject has a case history of tumours or is in remission.
- Do not treat any swollen or inflamed areas without seeking medical advice and without training in the LPG technique in this particular area.
- Make sure that the patient does not have a pacemaker to prevent electronic interferences.

Contra-indications:

Because of the risk of interference, it is important that the professional ensures the patient is not equipped with a personal medical device such as a pacemaker. If this is the case, the professional should obtain details about the device in question to ensure that any interference will not affect the correct use of the equipment.

- Do not treat a patient suffering from inexplicable and persistent pain without seeking medical advice and without training in the LPG technique in this particular area.
- Do not treat a patient following invasive medical treatment, without seeking the medical advice of the doctor or surgeon who performed this operation and without training in the LPG technique in this particular area.

For a more detailed list of the indications and contraindications of Endermologie, please refer to the training manuals.

As this list is not exhaustive, always seek out medical advice in the event of doubt.

Index

IDENTIFICATION RATING PLATE	P. 12
TIME METERS	P. 13
CLEANING THE UNIT	P. 14
REPLACING FILTER CARTRIDGES	P. 15
REPLACING FUSES	P. 16
INSTRUCTIONS FOR DISCONNECTING THE TREATMENT HEADS	P. 16
ACCESS TO THE TECHNICAL ITEMS	P. 17
REPLACING THE FILTERS OF THE VACUUM GENERATOR	P. 18
TRANSPORT/STORAGE	P. 19
MAINTENANCE KIT	P. 20
MAINTENANCE FILE	P. 20



This unit contains programs to help the operator obtain the best anticipated results for each case undergoing treatment. Under no circumstances may these programs be construed as a guarantee of successful treatment, which varies, depending on the morphology, physiology and eating behaviour of each patient.



ALL THE MAINTENANCE OPERATIONS DESCRIBED IN THIS SECTION MUST BE CARRIED OUT WITH THE UNIT SWITCHED OFF AND THE POWER CABLE DISCONNECTED.



Identification rating plate

Your unit is identified by a serial number shown on the rating plate. The rating plate also shows the permitted supply voltage for the unit.

If you need to contact LPG Systems because of a technical problem, please indicate the serial number of your Cellu M6 Keymodule [2]i.

This serial number provides information on the year and month of manufacture of your unit.

The letter gives the year of manufacture: V= 2005, W= 2006, X= 2007, Y= 2008, etc. The two figures indicate the month of production: 01= January, 02= February, 03= March, etc.



The corresponding icon indicates that the unit was sold after August 13, 2006. In conformity with the 2002/96/CE directive, it cannot be thrown away with standard household waste but must be disposed of by means of recycling.

By doing so, you help the environment by contributing to the conservation of natural resources and the protection of human health.

SERIAL NUMBER	
LPG SYSTEMS FABRIQUE EN FRANCE MADE IN FRANCE	TECHNIPARC DE LA PLAINÉ 8735, 30 RUE DU 14 JUILLET 38000 VALS-LES-BAINS CEDEX 03
TYPE: Cellu M6 KeyModule[2]i	CE 0088
N° SERIE: KM12V108787	IP 20
230V-50Hz / 1A / 920VA	DEBIT: 18,5 m³/h CAPACITY
VIDE MAXIMUM REGULE: ULTIMATE REGULATED SUCTION:	70kPa (700 mbar)
SUPPLY VOLTAGE AND FREQUENCY	YEAR AND MONTH OF MANUFACTURE



This pictogram means "Warning, please consult the user guide."



This pictogram means "Your device comprises a part that is in contact with the patient that is isolated electrically from all other parts of the device."

Time meters

Your unit comprises several TIME METERS that total the operating hours of the various units for periodic maintenance purposes. These meters can be seen at control panel level, from the CONFIGURATION screen .

- C1:** The Main Head Filter Counter totals the number of operating hours for the main head filter.
- C2:** The Auxiliary Head Filter Counter totals the number of operating hours for the auxiliary head filter.
- C3:** The Pump Filter Counter totals the number of operating hours for the pump.
- C4:** The Main Head User Counter totals the number of operating hours for the main head.
- C5:** The Keymodule User Counter totals the number of operating hours for the Key-module connected to the main head.

FROM THE CONTROL PANEL



Cleaning the unit

We recommend that you clean your unit as often as possible, not only for reasons of hygiene and aesthetics but also because cleaning the unit will help keep it in a good state of repair and extend its useful life.

Using a vacuum cleaner with a fine nozzle, clean the following sections:

- The inside of the access drawer to the auxiliary heads, (having already removed all the auxiliary heads).
- The inside of the access door to the filters.

Using a moist sponge, clean the following sections:

- All the external hoods.
- Hoses.
- The power cable.

Using a cloth soaked with a little domestic cleaning product not containing alcohol, clean the following sections:

- Control screen and control panel.
- The inside of the access drawer to the auxiliary heads.
- The inside of the access door to the filters.

Replacing filter cartridges

Your unit has 2 filters. One is for filtering the circuit of the main head while the other filters the circuit of the auxiliary heads. The filter cartridge guarantees the efficiency of your unit and extends its useful life.

Remember to change the cartridge every forty hours.

A warning message on the screen indicates that a filter needs changing. Open the filter access hood. Unscrew the filter cartridge and replace the cartridge with a new one.

Remember to purchase new filter cartridges from the LPG Systems Customer Service Department so you always have a spare.

Never use your device without filter.





Replacing fuses

Your unit is protected against short-circuits by 2 ceramic 6.3 mm x 32 mm time-delay fuses.

Fuse replacement:

1. Disconnect the supply cable from the mains.
2. Loosen one of the 2 fuse holders.
3. Remove the fuse.
4. Repeat the same operation for the second fuse holder.

Remember to purchase new fuses from LPG Systems Customer Services, so that you always have a spare on hand.



Instructions for disconnecting the treatment heads (cont'd)

Disconnecting the treatment heads and hoses is quick and easy.

1. Loosen the two screws and remove the rear screen located on the mobile arm, using the small, hex key.
2. Loosen and disconnect the electric connection.
3. Remove the plastic connection from its housing.
4. Disconnect the plastic connection.

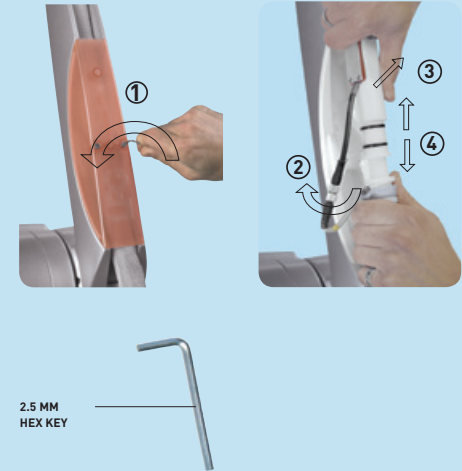

Instructions for disconnecting the treatment heads

Because of its rapid-fit twist connection, the main treatment head can easily be disconnected from its hose by loosening the aluminium connection bush.



To connect the head, take hold of the hose and proceed with its electrical connection and then screw tight by tightening the aluminium bush.

Access to the technical items

Disconnect the supply cable. Open the rear door to gain access to the technical elements using a screwdriver. Only loosen the 4 fixing screws a quarter turn.

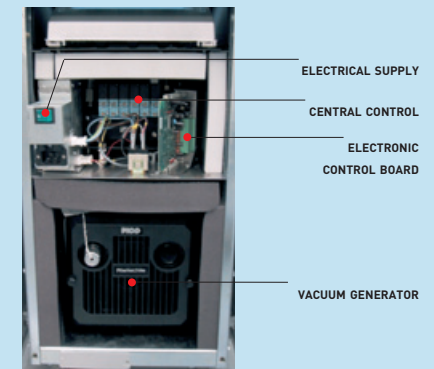

Replacing the filters of the vacuum generator

The vacuum generator has two filter cartridges:

- one paper cartridge at the inlet, on the left side,
- one metal cartridge on the discharge side, on the right side.

These two cartridges must be replaced after every 1.000 hours of operation.

No special tool is required for this operation.

1. Open the rear door to gain access to the technical elements.
2. Loosen the two knurled nuts of the vacuum generator hood.
3. Unscrew the cover.
4. Unscrew the central knurled nut.
5. Remove the cartridge from the spring.
6. Replace with a new cartridge.
7. Repeat the same operation for the second cartridge.
8. Once the new filters are in place, validate the operation by selecting the icon representing the filters you have just changed, by pressing the appropriate key and hold the VALID.

To confirm replacement, the icon depicting the filters disappears.



②



③



④



⑤



⑧



ACKNOWLEDGE REPLACEMENT BY PRESSING THE KEY FOR A LONG TIME

Transport/Storage

Where the unit is only being moved a short distance or when stored for a short while in the folded position, it is essential to insert the two shims provided for this purpose.

If you require any information on the packaging, shims and procedure to be adopted, please contact LPG Systems Customer Services.

1. Fix the treatment heads to their relevant support using large rubber bands.
2. Loosen the 4 screws using the large hex key.
3. Pull the top section of the unit upwards.
4. Bend while holding the unit.
5. Insert the various shims in order to protect the hoods.



HEX KEY, 5

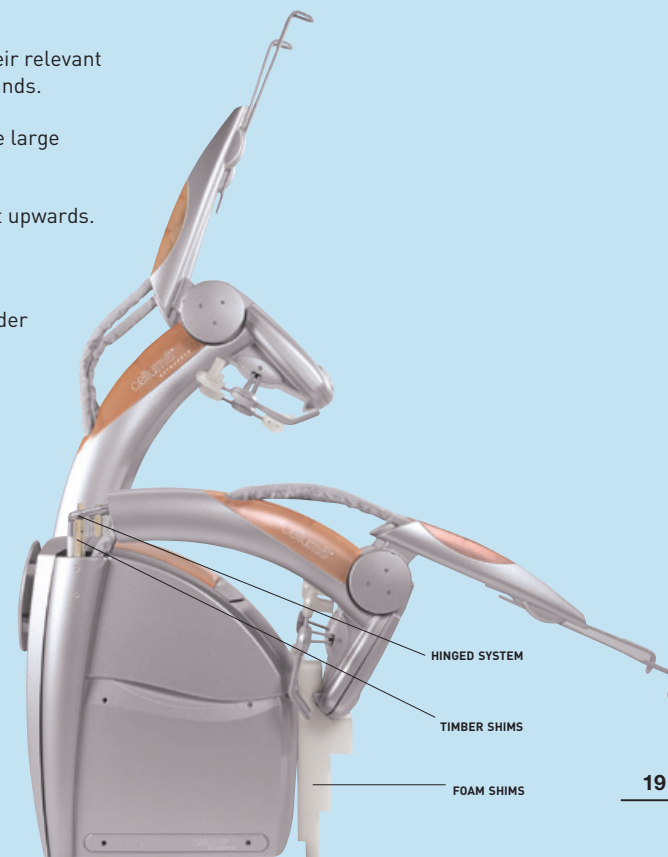

19

18

! It is important to replace the filter cartridges one after the other, so that the correct cartridge is replaced in its housing. The Cellu M6 must be switched off before proceeding with a filter cartridge change. The unit must also be cold, so as to avoid any risk of burning.

! LPG Systems will not be liable for damage caused by transport or storage in the folded position, if the shims provided for this purpose, are not in place.

Maintenance kit

The tools supplied with the equipment in the tool box are sufficient to carry out the maintenance operations defined in this guide.

Contents of the maintenance kit:

- 4 hole covers,
- 2 spare fuses,
- 2 hexagonal spanners (model: no. 2.5 and no. 5),
- 1 Torx T30 key,
- 1 Torx T10 key,
- 1 screwdriver.

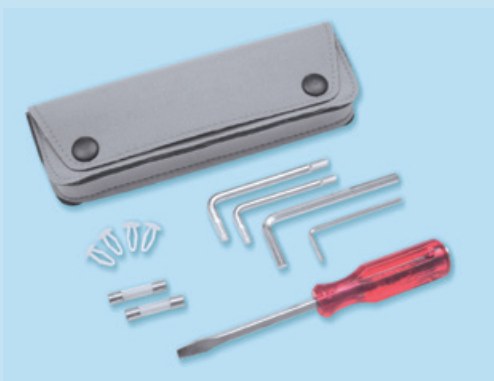

Maintenance file

Replacement of the filter cartridge for the main head circuit	40 hours
Replacement of the filter cartridge for the auxiliary head circuit	40 hours
Overhaul of the main head	approx. every 1.000 hours
Replacement of the vacuum generator filters	1.000 hours

Replacing the TML10: Once the TML10 flaps no longer permit proper skin treatment, they should be replaced. Use the TML10 airtight kit. The airtight kit should be replaced at most every 100 hours' of operation.

Replacing the TML19 and TML30: Once the TML19 and TML30 flaps no longer permit proper skin treatment, they should be replaced. Use the TML19 and TM30 airtight kits. These kits should be replaced at most every 250 hours' of operation.

DATE	NUMBER OF HOURS	OPERATIONS CARRIED OUT

A little problem! What should I do

If your unit is not working properly, proceed with the following checks before calling Customer Services:

- Is the unit properly connected to a mains plug?
- Is the mains plug live?
- Is the ON switch lit up?
- Are the fuses of the unit in good order?
- Are the filter cartridges clean and properly in place?
- Are the hoses free?
- Are the hoses properly connected to the mobile arms of the balancer?
- Are the sealing valves of the main head in their proper place, clean and moving?

- Is the Keymodule of the main head correctly fitted?
- When switching on, the main head screen is blocked in the MAINTENANCE MENU; there is a problem of compatibility between the electronic boards of the T70 and the Cellu M6 Keymodule [2]i. Please contact Customer Services of your distributor.

Once these checks have been carried out and if the malfunction persists, please contact Customer Services of LPG Systems or the nearest authorized dealer, indicating the model of your unit, its serial number and operating time in hours (see access to the time meters).

General characteristics

Dimensions: Length x width x height 60 x 46 x 210 cm
 Net weight 90 kg
 Maximum set depression 69 kPa (690 mbar)
 Fuses Time-delay
 Size 6.3 x 32 mm
 Cooling By way of mechanical ventilation incorporated in the pump
 Protection index IP 20
 Electrical protection class 1
 Operating temperature +10°C to +30°C (+50°F to +86°F)
 Storage temperature -20°C to +70°C (-4°F to +158°F)

Unit fitted with patented treatment heads.



The Cellu M6 Keymodule [2]i is marked  as a medical device by virtue of Annex V of regulation 93/42/EEC (standards 60601-1-1 and 60601-1-2).

Electrical properties

230V - 50 Hz

Supply voltage 230V AC
 Frequency 50 Hz
 Intensity consumed 4A
 Power consumed 920 Watts
 Ceramic fuses T8A

220V - 60 Hz

Supply voltage 220V AC
 Frequency 60 Hz
 Intensity consumed 4.8A
 Power consumed 1.100 Watts
 Ceramic fuses T8A

Electrical properties

127V - 60 Hz

Supply voltage 127V AC
 Frequency 60 Hz
 Intensity consumed 10A
 Power consumed 1.200 Watts
 Ceramic fuses T12.5A

100V - 60 Hz

Supply voltage 100V AC
 Frequency 60 Hz
 Intensity consumed 12.5A
 Power consumed 1.250 Watts
 Ceramic fuses T20A

100V - 50 Hz

Supply voltage 100V AC
 Frequency 50Hz
 Intensity consumed 12.5A
 Power consumed 1.000 Watts
 Ceramic fuses T20A



TREATMENT HEAD

cellum6ⁱ
KEYMODULE
(2)



Registered trademark

Contents

7.A	DESCRIPTION OF MAIN HEAD T70.....	P. 26
7.B	DESCRIPTION OF KEYMODULE.....	P. 27
7.C	FUNCTIONS INCORPORATED IN THE MAIN HEAD	P. 30
7.D	DESCRIPTION OF MICRO-HEADS/NOZZLES	P. 31
7.E	DESCRIPTION OF LIFT HEADS	P. 31
7.F	FUNCTIONS INCORPORATED IN THE AUXILIARY ADAPTER	P. 32
7.G	DESCRIPTION OF AUXILIARY HEADS	P. 32
7.H	MAINTENANCE	P. 33



Main head T70



Keymodule®

The Keymodule is the bottom interchangeable section of the T70 main head. It comprises the motorised rollers and sealing valves.

You have three Keymodule, the characteristics of which differ from the motorized rollers in several points:

- Diameter and texture of the rollers.
- Rigidity of return springs on motorised rollers.
- Roller length.

Keymodule i 1:

It is characterised by the following points:

- Roller diameter: 26 mm.
- Hard springs.

Keymodule i 2:

It is characterised by the following points:

- Roller diameter: 28 mm.
- Soft springs.

Movement and direction of rotation are visually displayed by LEDs for these Keymodule.

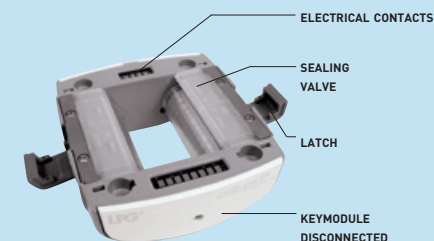
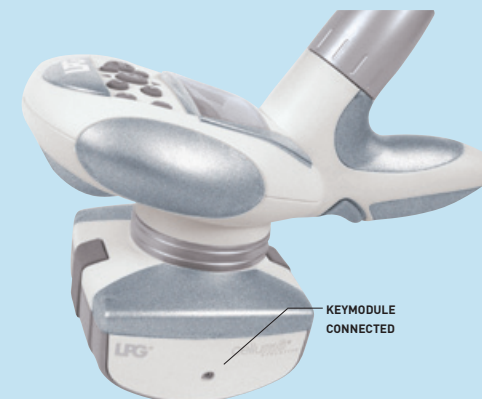

Before running your unit for the first time, ensure that a Keymodule is properly connected to the T70.

Keymodule®

Keymodule i 50:

is adaptable to the main head of the Cellu M6 Keymodule [2]i T70. It consists of two motorised rollers and airtight valves.

It is characterized by the following points:

- Roller diameter: 26 mm.
- Roller length: 50 mm.
- Soft springs.
- The depth of treatment can be selected by setting the rollers a distance of between 28 and 10 mm apart.

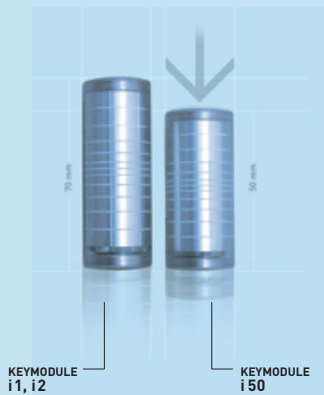
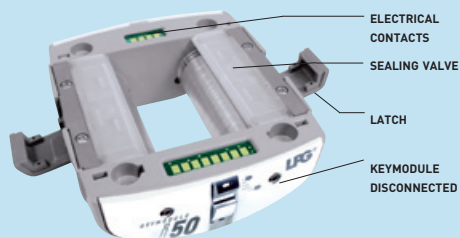
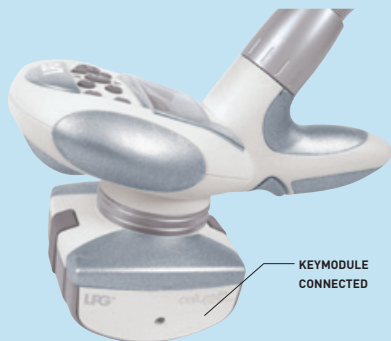

Installation

Every Keymodule is designed to be compatible with the main head T70.

Attach the Keymodule to the main head as shown in the photos opposite.

To remove the Keymodule release the latches.

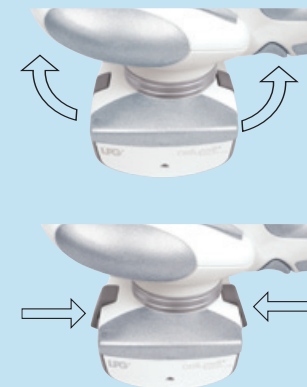

Setting the cursor of keymodule i1, i2 and i50

The Keymodule **i1**, **i2** and **i50** have a cursor, which can be adjusted to 5 positions, thereby making it possible to adjust the spacing between the motorized rollers.

When the cursor is in the bottom position (figure 1) the distance between centres of the rollers is maximum and fixed, there is no roller mobility.

When the cursor is in the top position (figure 2) the distance between centres of the rollers is variable, from a maximum position to a minimum position, which ensures maximum mobility of the rollers.

When the cursor is in one of the 3 intermediate positions (figure 3) the distance between centres of the rollers, as well as their mobility, are variable.

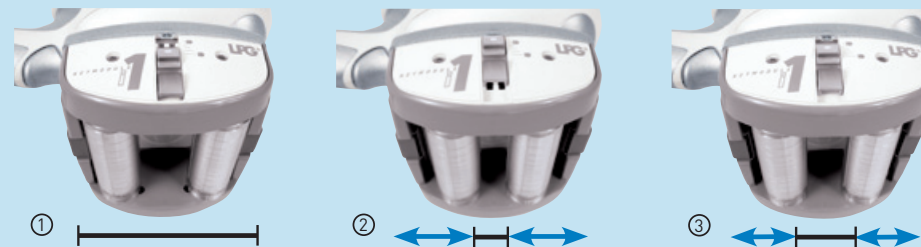

Functions incorporated in the main head

Apart from roller speed settings, frequency or treatment mode (Roll'in or Roll'up), the main head also incorporates the Start/Stop and reverse functions and the roller direction indicator.

Start/Stop:

Once the pump has been switched on via the START button on the control screen, starting and stopping the treatment can be controlled from the main head:

To start treatment, squeeze the trigger briefly.

To stop treatment, squeeze the trigger for a longer period. This function can also be enabled via the START/STOP button on the head.

Direction of movement indicator (when the rollers are moving in the same direction):

Each squeeze of the trigger reverses the direction the head moves in.

Throughout the treatment, the direction of movement of the main head is shown by flashing lights.

Reverse mode and LEDs:

In reverse mode (the rollers are turning in opposite directions) the way the LEDs flash becomes more specific:

- in roll'out mode (the 2 rollers roll in the fold), the 2 LEDs are lit and flash,
- in roll'in mode (the 2 rollers roll out the fold), the 2 LEDs stay lit.

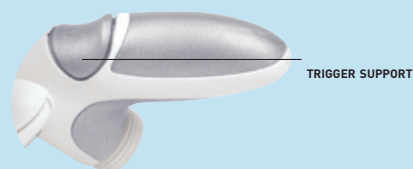

Micro-nozzles and micro-heads serie 600

SUPPORT (COMMON TO ALL THE MICRO-NOZZLES AND ALL MICRO-HEADS)



Lift heads



Adjusting the force with which the flaps return:

To guarantee that the flaps return effectively and therefore to optimize treatment, it is important to adjust the knob in line with the intensity of the treatment and the program selected.

- Turn the knob from A to G to increase the flap's return force.
- Turn the knob from G to A to reduce the flap's return force.

Functions incorporated in the auxiliary adapter

Because the control is incorporated in the auxiliary head connection, you can start or stop your treatment by operating the START/STOP switch and adjust the treatment intensity using the +/- keys without having to go to the control panel of your unit.



Auxiliary heads serie 600 - active



Cleaning the auxiliary heads

When used for specific purposes such as the after-effects of burns or lymphoedema, the treatment heads must be thoroughly disinfected after use:

1. After following the cleaning procedure described above, soak the head (auxiliary head, micro-head and micro-nozzle) and the rollers in a disinfectant solution for 15 minutes.

2. Rinse carefully.

3. Leave to dry.

Warning: Use a non-alkaline disinfectant that complies with AFNOR standards and has the following microbiological properties: Bactericide (NF EN 1040, NF T 72-171, NF T 72-190, T 72-300/301), Fungicide (NF EN 1275, NF T 72-200).

Cleaning the lift heads

For reasons of hygiene, the treatment heads should be cleaned before and after each use with the heads disconnected from the machine. Use antiseptic wipes and a bactericidal and fungicidal solution.

Lift head:

1. Before use, clean the flaps and the side plates.
2. After use, remove the flaps from the head for more thorough cleaning. Grasp the flaps between the thumb and index finger and pull them upwards.
3. Next clean the head's transparent side plates with antiseptic wipes and a bactericidal and fungicidal solution.

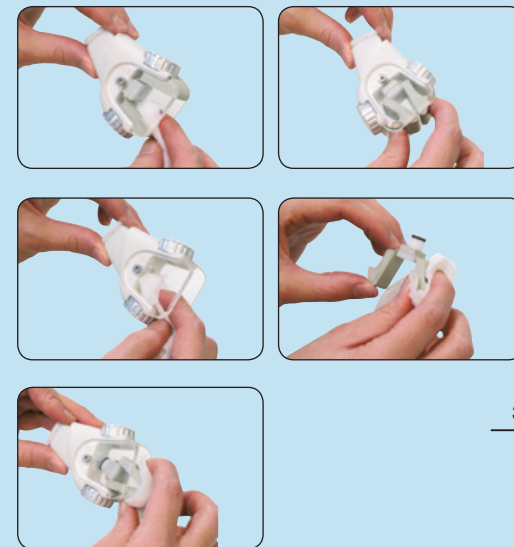

Cleaning the lift heads (cont'd)

4. Clean the flaps in the same way.
5. Once cleaning is complete, refit the flaps by pushing them back into their housing, holding them with the antiseptic wipe.

Removing the TML10 flaps:

The TML10 flaps can be removed and refitted using the special extractor tool.

1. To remove the flaps, hold the extractor tool's sides in, then release them and pull out both the tool and the flaps.
2. To remove the flaps from the tool, press in on the sides of the tool.
3. Once cleaning is complete, replace the flaps as shown below.

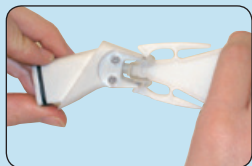
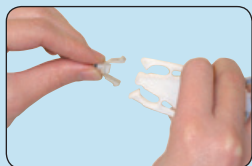

Replacing the flaps/airtight kit

Once the flaps no longer permit proper skin treatment, they should be replaced. Use the flaps provided with the machine or order an airtight kit from the Customer Service of your distributor.

1. TML10 airtight kit.
2. TML19 and TML30 airtight kit.
3. Using the hex key provided in the kit, remove the side plates by unscrewing the two screws and replace them with the new ones.
4. Remove the sealing ring from the treatment head connector and replace it with the new one.

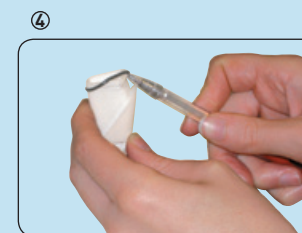
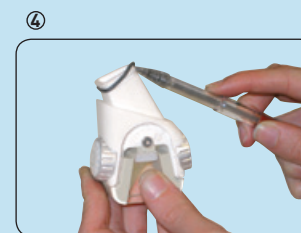
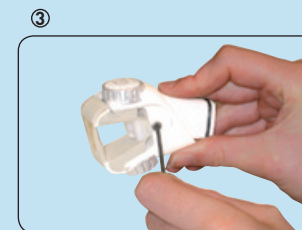

Cleaning the main head

For hygiene reasons, the treatment heads must be cleaned after each use, using antiseptic wipes with a bactericidal and fungicidal solution.

Special attention must be paid to those parts coming into contact with the patient.

Cleaning the tightness valves:

1. Release the Keymodule as shown on the photos.
2. Make sure that the cursor is in the top position.
3. Bring the roller to the center.
4. Remove the corresponding sealing valve by handling it as shown on the photo. Repeat this operation for the other valve.
5. Then clean the valves and their location.

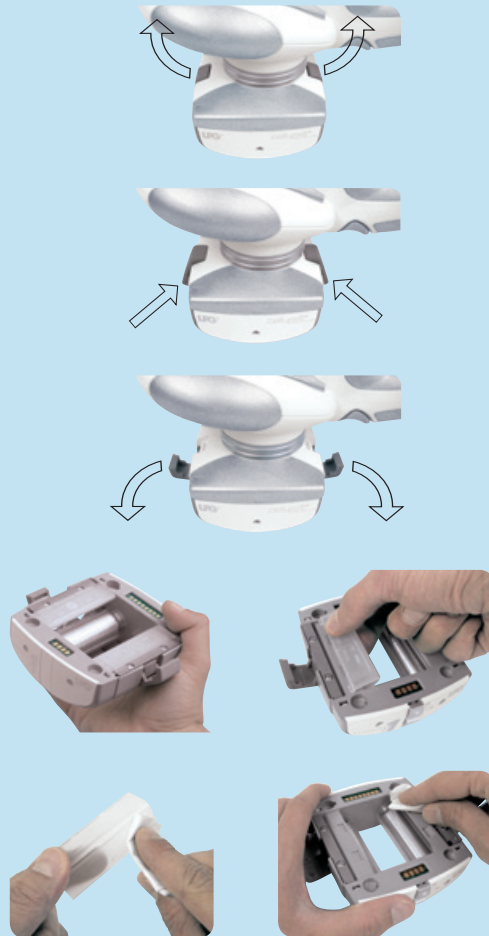

Replace the valves after: **100 hours' operation.**

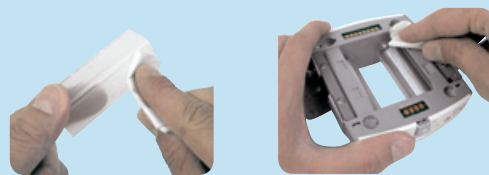

Cleaning the main head

Cleaning the Keymodule:

1. Turn the Keymodule and clean the rollers on either side. Manually turn the rollers so as to gain access to the entire surface area.
2. Turn the Keymodule again and refit the sealing valves as shown on the photos.
3. Do not forget to clean the sealing joint between the Keymodule and head body.
4. Check that the electrical contacts are clean and dry and proceed in the reverse sequence to refit the Keymodule onto the main head.

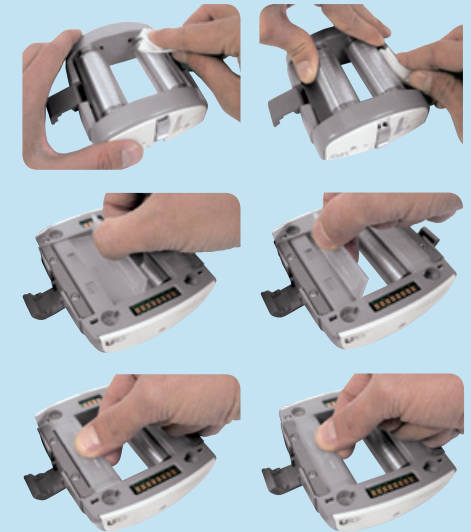

Now check that the head is operating correctly. To do this, operate the head in the palm of your hands to ensure the correct sealing of the treatment chamber and visually inspect the movement of the valves and that of the rollers.

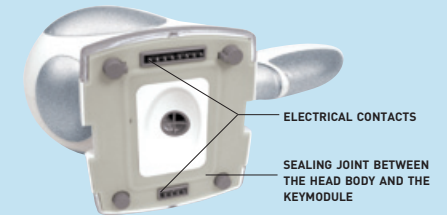

WARNING: if the Keymodule is not fitted to the main head, if it is incorrectly positioned or even faulty, the main head screen will display the icon alongside:

Check the assembly of the Keymodule.



Cleaning the auxiliary heads micro-heads and micro-nozzles

For hygiene reasons, the treatment heads must be cleaned after each use, using wipes containing an antiseptic, bactericidal and fungicidal* solution.

Cleaning the auxiliary heads:

1. Disconnect the auxiliary head of the adapter for cleaning purposes.
2. Remove the two head rollers to proceed with quick and efficient cleaning as shown on the photograph. For micro-heads, use the micro-head tool supplied.
3. Clean the rollers and the treatment chamber.
4. Refit the rollers and check that they rotate freely.
5. For cleaning the micro-nozzles, use cotton swabs containing the same solution.



Overhaul of the Keymodule®

The Keymodule is a high-technology unit comprising numerous mobile micro-mechanical parts. The unit must be returned to our Technical Support Center if certain wear

items require replacing. The head may start to lose some of its characteristics at around 1.000 hours of operation.



General warranty conditions

You have recently acquired an appliance distributed by LPG Systems or an LPG Systems approved distributor. It is the purchaser/user's responsibility to find out from the local authorities the conditions and professional qualifications that should be met before using the appliance.

The purchase of this equipment implies the legal acceptance by the purchaser/ professional user of these general warranty conditions. If the appliance was sold to you by an approved LPG Systems distributor, the purchaser/user should refer to the supplier's warranty conditions. These may in no way increase the undertakings made in these present warranty conditions. The warranty can only be implemented and is only valid if the warranty slip has been duly filled out and returned to LPG Systems within two weeks of delivery, irrespective of the country. Warranty slips that are only partially completed will be rejected.

The appliance is guaranteed against manufacturing flaws and defects in the raw materials. The warranty extends for the shorter of the following two periods: one (1) year OR two thousand (2.000) hours of use from the invoice date. During this period, LPG Systems undertakes to exchange or repair free of charge, as quickly as possible, any part that LPG Systems acknowledges as defective, however LPG Systems does not undertake to replace the entire appliance. Traveling and living expenses for our technicians and transportation costs of the appliance or parts to and from the after-sales service workshop are not covered by

this warranty. Replacements and repairs performed within this warranty, with or without immobilization of the equipment, shall not have the effect of extending the warranty period. Replaced parts become the property of LPG Systems or the approved distributor. No compensation shall be paid for loss of use. The purchaser/user is required to allow LPG Systems the necessary time and means to carry out all repairs and deliveries of replacement spare parts, Failure to comply will absolve us from our obligations under the warranty.

The only courts of competent jurisdiction are those within the legal district of LPG Systems' head office regardless of any jurisdiction clauses in any other document.

Warranty exclusions:

- Damage occurring during transportation. Transportation of this equipment and/or spare parts is at the recipient's own risk. Before taking delivery, it is the recipient's responsibility to verify the state of the goods and to make a claim against the transport company in the manner usual in the delivery country.
- Non-observance of the installation and operating instructions, failure to carry out maintenance and/or negligence in maintaining the appliance and/or its filter cartridges, connection to a faulty electricity supply or a non-earthed electricity supply or a power supply whose voltage is different to the one indicated on the appliance.





General warranty conditions (cont'd)

• If an appliance is sold before the end of the warranty period, the warranty is transferred to the purchaser for the remaining warranty period, on the condition:

i) that the original invoice is provided,

ii) that the initial vendor is informed of the sale.

• Modification, mounting of accessories or dismantling of the equipment.

• Any operation and/or intervention not specified in the LPG Systems Operating Instructions and performed on the equipment by the purchaser/user and/or any

party not approved by LPG Systems.

• Use of consumables, spare parts, inappropriate components or parts not supplied by LPG Systems.

• Blockage of the appliance through aspiration of a foreign body.

• Normal wear and tear of any of the equipment's parts resulting from normal usage.

• Falls, impacts, lightning, fire, force majeure, water damage and natural disasters.

Limitation and exoneration of liability

Non-compliance with the general guarantee conditions during the term of the warranty and following expiry of the latter, may lead to LPG Systems being exonerated of any liability in the event of damage attributed to the products supplied.

LPG Systems will not be held liable with respect to equipment/material losses or physical accidents (i), following installation that does not comply with the statutory or regulatory provisions of the country where the unit is to be used or (ii) which could

jeopardize a Cellu M6 Keymodule [2]i unit, which was the subject of intervention work not scheduled in the LPG Systems operator's manual and/or carried out by the operator or a third party not authorized by LPG Systems.

LPG Systems will be absolved of its liability in the event of use exceeding the level of professional competence/qualification of the operator or resulting from the incorrect use of the unit.

To be filled in by the manufacturer

LPG SYSTEMS S.A.
Technoparc de la Plaine
30, rue du docteur Abel - BP n° 35
26902 VALENCE Cedex - France
RCS Romans B 335 183 836

Tel.: +33 (0)4 75 78 69 00 - Fax: +33 (0)4 75 42 80 85

Type of unit: **Cellu M6 Keymodule [2]i**



To be completed and return to LPG Systems

Name:.....

Adress:.....

Country:.....

Tel.:

Type of establishment:

Profession:.....

Type of unit: **Cellu M6 Keymodule [2]i**

Serial number:

Date:



To validate the warranty, detach this slip and return to the address below within 15 days following use of the unit:

LPG SYSTEMS S.A. - Technoparc de la Plaine
30, rue du docteur Abel - BP n° 35 - 26902 VALENCE Cedex 9 - France

Endermologie® Photo System

A real high-tech benchmarking and diagnosis tool, Endermologie Photo System enables practitioners to document areas to be treated or respected and to rationalize the results.

Endermologie Photo System puts patients into position in a matter of seconds, and ensures the positions used can be reproduced and compared. In this way, real comparisons can be made, before and after treatment. Digital photography facilitates storage and use of the photographs and respects privacy.

Endermologie Photo System is an essential, logical complement to the LPG Technique.



LPG® Bodywear

LPG advises patients to wear the “LPG Bodywear” during their treatment sessions. Apart from the advantages relating to its use (resistance, hygiene, respect of privacy, easier working conditions for the practitioner) this high quality garment is made of non-abrasive materials and minimizes damage from the Keymodule.



42

It is available in different sizes:

- Medium (up to French size 42 or 1 m 70);
- Large (over French size 42 or 1 m 70);
- Men (one size).

LPG Bodywear is available from the Customer Service of your distributor.